

BJ810

圆锥状支撑



BJ810-F
(前端研磨型)



BJ810-R
(前端R型)



BJ810-S
(前端锯齿型)

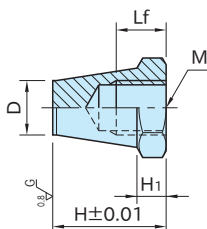
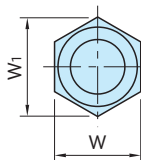

BJ810-F
(前端研磨型)

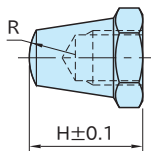

BJ810-R
(前端R型)

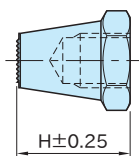
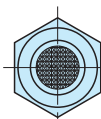

BJ810-S
(前端锯齿型)

本体
S15C
渗碳淬火
四氧化三铁膜

规格		H	D	W	W ₁	H ₁	M	Lf	R	质量 (g)
BJ810-F BJ810-R BJ810-S	06012	12.5	6	11	12.7	3	M 6×1	4	5	5
	06025	25						7		8
	08015	15	8	13	15	4	M 8×1.25	6	8.5	9
	08030	30						9		18
	10020	20	10	17	19.6	5	M10×1.5	9	9	17
	10040	40						13		35
	12025	25	12	19	21.9	6	M12×1.75	11	12.8	25
	12050	50						16		62

前端研磨型 型号	前端R型 型号	前端锯齿型 型号
BJ810-06012-F	BJ810-06012-R	BJ810-06012-S
BJ810-06025-F	BJ810-06025-R	BJ810-06025-S
BJ810-08015-F	BJ810-08015-R	BJ810-08015-S
BJ810-08030-F	BJ810-08030-R	BJ810-08030-S
BJ810-10020-F	BJ810-10020-R	BJ810-10020-S
BJ810-10040-F	BJ810-10040-R	BJ810-10040-S
BJ810-12025-F	BJ810-12025-R	BJ810-12025-S
BJ810-12050-F	BJ810-12050-R	BJ810-12050-S